

Baptist University Road Campus - Renovation Works on G/F of Student Residence Halls (SRH)

浸會大學道校園 - 學生宿舍地下翻新工程

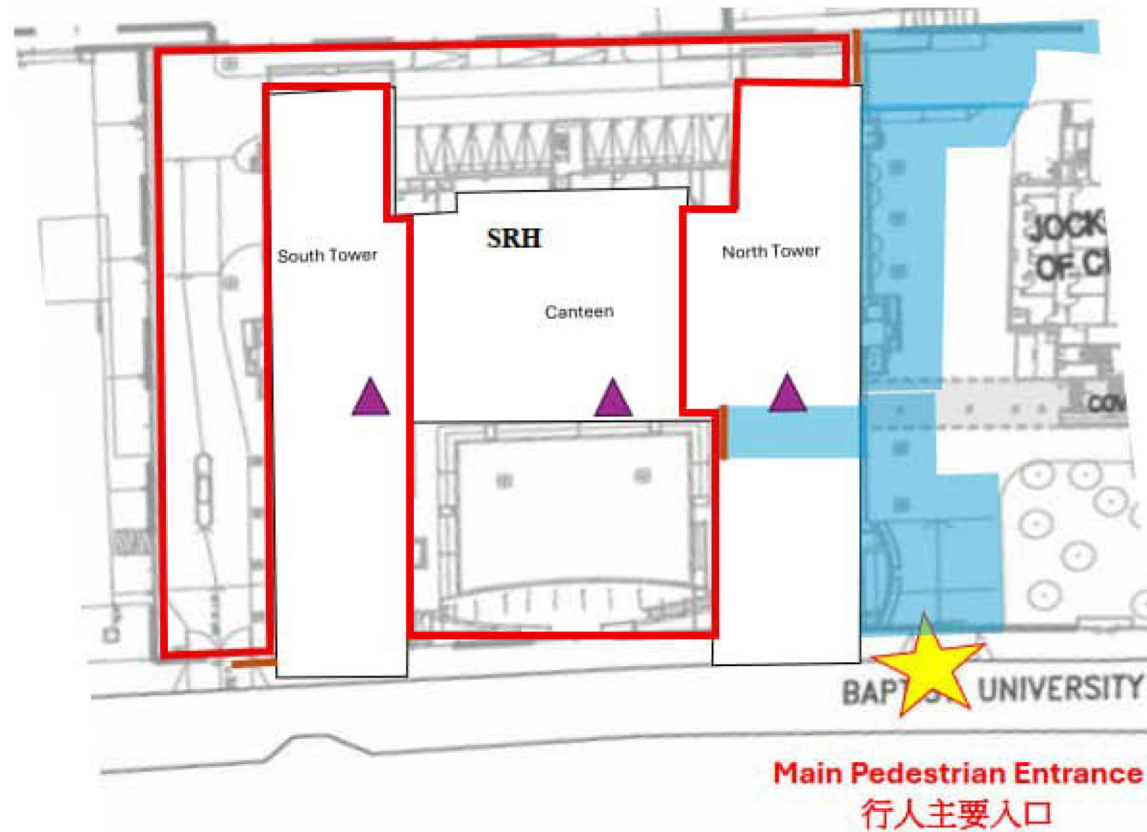

Legend 圖例

-  Location of SRH G/F affected area
學生宿舍地下受影響範圍
-  Temporary Closure of Entrance Gate
入口關門暫時關閉
-  Pedestrian Access
行人通道