

# Baptist University Road Campus - Temporary Closure of Part of the Driveway, Passageway and Entrance Gate near South Tower

## of Student Residence Halls (SRH)

浸會大學道校園 — 臨時封閉學生宿舍南座對出部分車道、行人路及閘口



**Temporary closure of Entrance Gate**

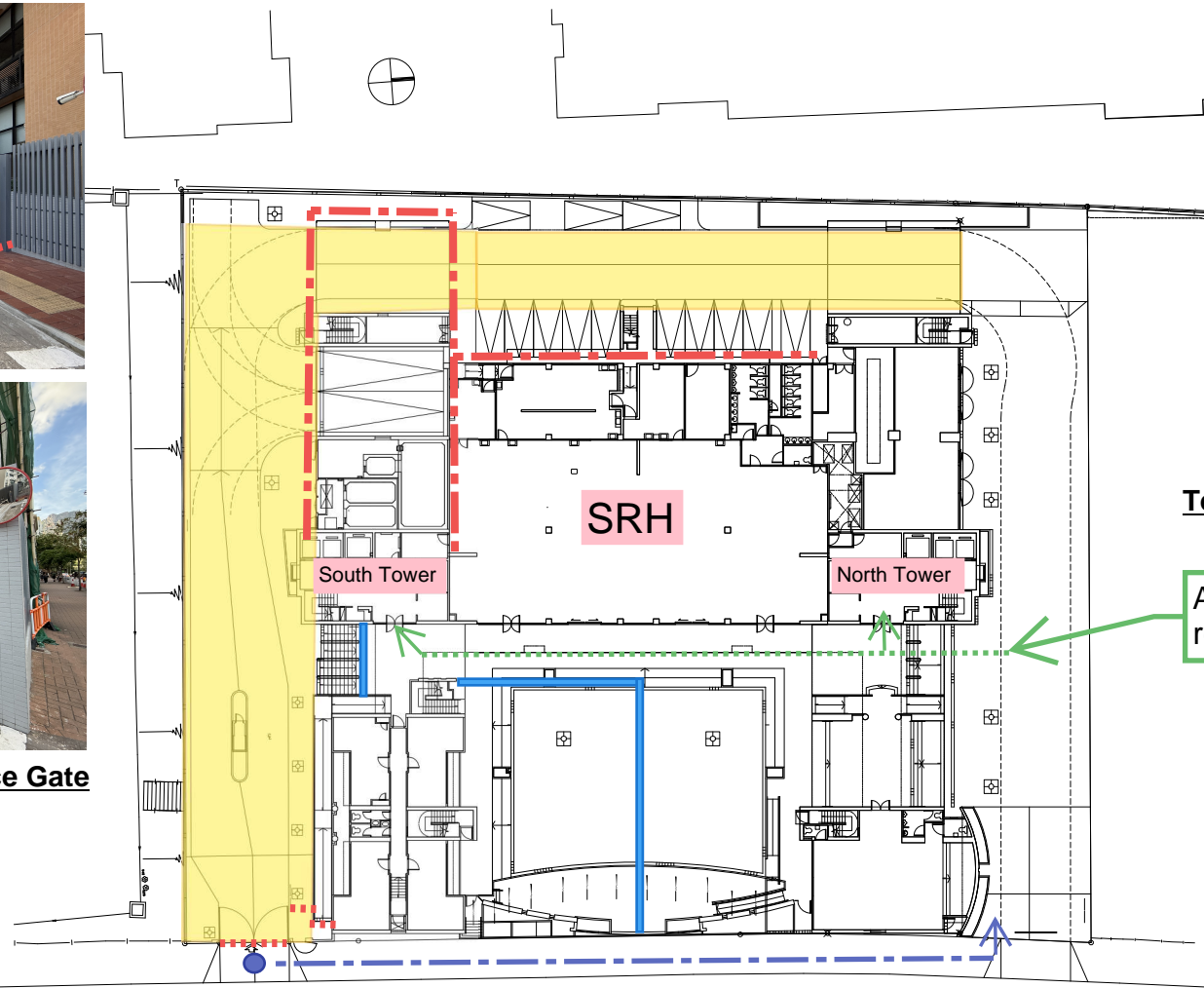

**Temporary closure of Passageway by Water Barriers**

Access route to SRH remains unaffected

### LEGENDS



WORKS AREA



AFFECTED AREA



ALTERNATIVE ROUTE FOR PEDESTRIAN



TEMPORARY BLOCKAGE OF EXISTING GATE



TEMPORARY BLOCKAGE OF PASSAGEWAY AND COURTYARD

Student Residence Hall  
G/F