

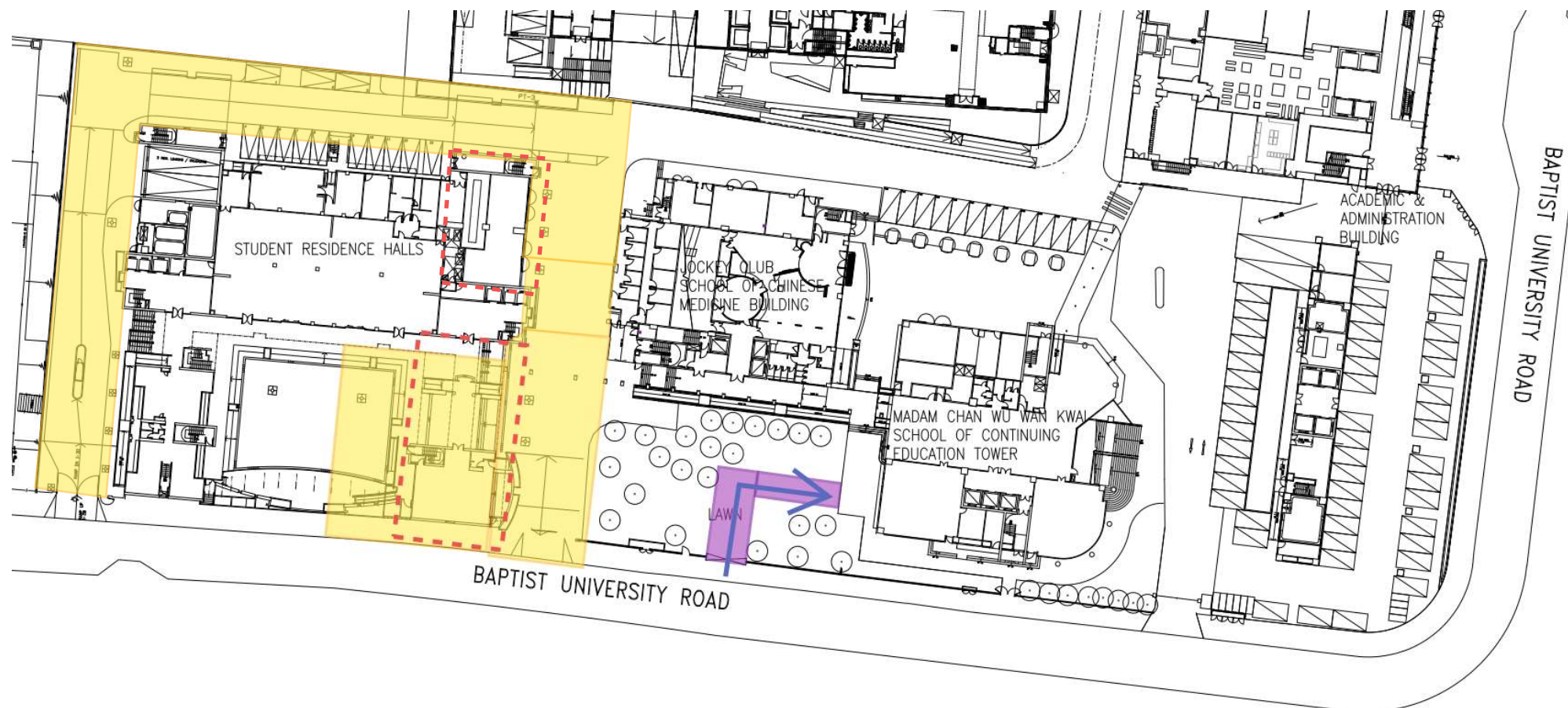



Baptist University Road Campus – Temporary Closure of Part of the Driveway and Passageway near North Tower of Student Residence Halls (SRH)

浸會大學道校園 – 臨時封閉學生宿舍北座對出部分車道及行人路



LEGENDS

-  **WORKS AREA**
-  **AREA CLOSED OFF**
-  **TEMPORARY ACCESS PATH**

BAPTIST UNIVERSITY ROAD CAMPUS GROUND FLOOR PLAN